

Soils Map-CSR2

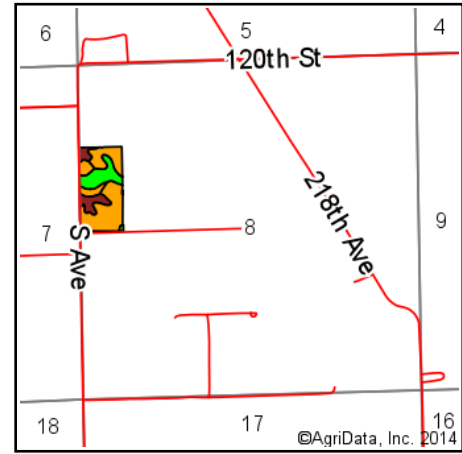

State: **Iowa**
 County: **Louisa**
 Location: **8-74N-4W**
 Township: **Columbus City**
 Acres: **20.48**
 Date: **7/7/2014**

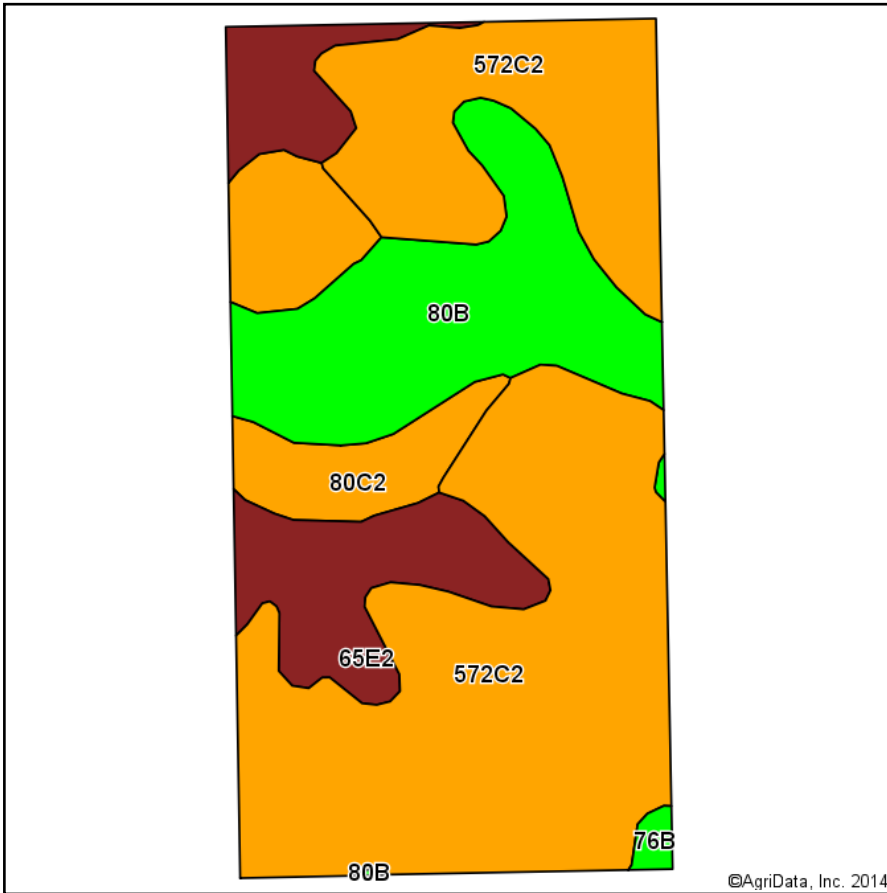
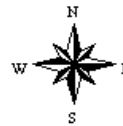

Maps Provided By:
surety
 CUSTOMIZED ONLINE MAPPING
 © AgriData, Inc. 2014 www.AgriDataInc.com

Area Symbol: IA115, Soil Area Version: 17

Code	Soil Description	Acres	Percent of field	**CSR2 Legend	Non-Irr Class	CSR2**	CSR
572C2	Inton silt loam, 5 to 9 percent slopes, moderately eroded	11.47	56.0%		IIIe	69	57
80B	Clinton silt loam, 2 to 5 percent slopes	3.96	19.3%		Ile	80	80
65E2	Lindley loam, 14 to 18 percent slopes, moderately eroded	2.86	14.0%		VIe	28	28
80C2	Clinton silt loam, 5 to 9 percent slopes, moderately eroded	2.07	10.1%		IIIe	69	60
76B	Ladoga silt loam, 2 to 5 percent slopes	0.12	0.6%		Ile	86	85
Weighted Average						65.5	57.9

Area Symbol: IA115, Soil Area Version: 17

**IA has updated the CSR values for each county to CSR2.

Field borders provided by Farm Service Agency as of 5/21/2008. Aerial photography provided by Aerial Photography Field Office.